

Licensing Committee Agenda

HEARING TO CONSIDER AN APPLICATION FOR A NEW PREMISES LICENCE

This meeting will consider only licensing matters delegated under the Licensing Act 2003

21st November at 1.30pm

Remote Meeting

MEMBERS OF COMMITTEE INVITED TO ATTEND HEARING

Councillor R. Lee (Chair)
Councillor D. Clark (Vice Chair)

and Councillors A. Davidson and P. Wilson

Local people are welcome to attend this meeting remotely, where your elected Councillors take decisions affecting YOU and your City. If you would like to find out more, please telephone Dan Sharma-Bird in the Democracy Team on Chelmsford (01245) 606523 or email dan.sharma-bird@chelmsford.gov.uk.

Licensing Committee

21st November 2023

AGENDA

1. Apologies for Absence

2. Declaration of Interests

All Members are reminded that they must disclose any interests they know they have in items of business on the meeting's agenda and that they must do so at this point on the agenda or as soon as they become aware of the interest. If the interest is a Disclosable Pecuniary Interest they are also obliged to notify the Monitoring Officer within 28 days of the meeting.

3. Licensing Act 2003 – Application for a new Premises Licence – 5 The Vineyards, Great Baddow, Chelmsford, Essex, CM2 7QS



Chelmsford City Council Licensing Committee

21st November 2023

LICENSING ACT 2003 – APPLICATION FOR A NEW PREMISES LICENCE: 5 THE VINEYARDS, GREAT BADDOW, CHELMSFORD, ESSEX, CM2 7QS

Report by: Director of Public Places

Officer Contact:

Callum Roberts, Licensing Officer, Callum.Roberts@chelmsford.gov.uk, 01245 606202

Purpose

The purpose of this report is for members to consider a Premises Licence Application made by Alliance Property Holdings Limited, under section 17 of the licensing act 2003, for a new premise licence in respect of 5 The Vineyards, Great Baddow, Chelmsford, Essex, CM2 7QS having regard to representations received and the requirement to promote the four licensing objectives. These are:

- a) The prevention of crime and disorder
- b) Public Safety
- c) The prevention of public nuisance
- d) The protection of children from harm

Recommendations

Members are advised that they have the following options when determining this application;

- Grant the application, on the terms and conditions applied for
- Grant the application on the terms and conditions applied for, modified to such extent as considered appropriate to promote the licensing objectives.
- Refuse the application in whole or in part.

An appeal in respect of any determination made in connection with this application may be made to the Magistrates Court, within 21 days of the notification given by the licensing committee, by the licence holder, Chief officer of police, or any other person making relevant representation.

1. Background

- 1.1 The area proposed is a Convenience store located within a residential area.

2. Application

- 2.1 The application has been properly given in accordance with The Licensing Act 2003 and all procedures correctly followed. The completed application form as well as the operating schedule are attached as **Appendix A**.
- 2.2 A complete application was submitted on the 29th September 2023, and correctly advertised by placing blue public notices at the premises and by publication in a local paper and on Chelmsford City Council's website.
- 2.3 The new premises licence application provides for the following licensable activities as detailed below:
Sale or supply of Alcohol Monday – Sunday 06:00 – 23:00
- 2.4 Mr Daniel Duncan has been nominated as the designated premises supervisor having obtained a personal licence from Southend Council.
- 2.5 The applicant has provided an operating schedule which promotes all four of the licensing objectives and have agreed additional conditions with Essex Police Licensing Unit.
- 2.6 Members are asked to note that as this report is available in the public domain, personal details have been redacted from some documents, however, both the Authority and the applicant have received complete copies of all documents.

3. Representations

- 3.1 During the course of the application, Chelmsford City Council, in line with the Act, sent a copy of the application to all responsible authorities.
- 3.2 During the consultation period two representations were received objecting to the application. A copy of these objections are shown as **Appendix B**.
- 3.3 Please see attached the conditions agreed with Essex Police as **Appendix C**.
- 3.4 Please find attached plans of the proposed licensable area as well as an image from Google maps showing the surrounding area as **Appendix D**.

4. Conclusion

- 4.1 The below sections of the Statement of Licensing Policy are brought to the attention of members:
- Section 13. (Licensing Committee) Nothing in the section affects this application.
- 4.2 This application has been correctly submitted.
- 4.3 At the conclusion of this hearing members are advised to consider the options as previously recommended at the start of this report.

Appendices:

- Appendix A – Copy of the Premises Licence Application and Operating Schedule
- Appendix B – Copy of representations received
- Appendix C – Conditions agreed with Essex Police
- Appendix D – Plans and Google maps image

Background reading:

Application held by Licensing Authority

Corporate Implications

Legal/Constitutional: None

Financial: None

Potential impact on climate change and the environment: None

Contribution toward achieving a net zero carbon position by 2030: None

Personnel: None

Risk Management: None

Equality and Diversity: None

Health and Safety: None

Digital: None

Other: None

Consultees: As per that required by legislation

Relevant Policies and Strategies: Statement of licensing policy

* required information

Section 1 of 21

You can save the form at any time and resume it later. You do not need to be logged in when you resume.

System reference This is the unique reference for this application generated by the system.

Your reference You can put what you want here to help you track applications if you make lots of them. It is passed to the authority.

Are you an agent acting on behalf of the applicant?

☒ Yes ☐ No

Put "no" if you are applying on your own behalf or on behalf of a business you own or work for.

Applicant Details**Name**

First name

Family name

Contact Details

E-mail

Telephone number

Fax number

Other telephone number

☐ Indicate here if the applicant would prefer not to be contacted by telephone

Is the applicant:

- ☒ Applying as a business or organisation, including as a sole trader
☐ Applying as an individual

A sole trader is a business owned by one person without any special legal structure. Applying as an individual means the applicant is applying so the applicant can be employed, or for some other personal reason, such as following a hobby.

Applicant Business

Is the applicant's business registered in the UK with Companies House? ☒ Yes ☐ No

Is the applicant's business registered outside the UK? ☐ Yes ☒ No

Continued from previous page...Commercial register Registration number Business name

If the applicant's business is registered, use its registered name.

VAT number

Put "none" if the applicant is not registered for VAT.

Legal status Applicant's position in the business Home country

The country where the applicant's headquarters are.

AddressBuilding number or name Street District City or town County or administrative area Postcode Country **Address**Building number or name Street District City or town County or administrative area Postcode Country **User Profile****Name**First name Family name

Continued from previous page...

Contact Details

E-mail	<input type="text"/>
Telephone number	<input type="text"/>
Fax number	<input type="text"/>
Other telephone number	<input type="text"/>

☐ Indicate here if you would prefer not to be contacted by telephone

Are you:

- ☒ Applying as a business or organisation, including as a sole trader
☐ Applying as an individual

A sole trader is a business owned by one person without any special legal structure. Applying as an individual means you are applying so you can be employed, or for some other personal reason, such as following a hobby.

Your Business

Is your business registered in the UK with Companies House? ☒ Yes ☐ No

Is your business registered outside the UK? ☐ Yes ☒ No

Commercial register

The entity with which your business is registered, for example "Amsterdam Chamber of Commerce".

Registration number

Business name

If your business is registered, use its registered name.

VAT number

Put "none" if you are not registered for VAT.

Legal status

Your position in the business

Home country

The country where the headquarters of your business is located.

Continued from previous page...

Address

Building number or name

Street

District

City or town

County or administrative area

Postcode

Country

Address

Building number or name

Street

District

City or town

County or administrative area

Postcode

Country

Section 2 of 21**PREMISES DETAILS**

I/we, as named in section 1, apply for a premises licence under section 17 of the Licensing Act 2003 for the premises described in section 2 below (the premises) and I/we are making this application to you as the relevant licensing authority in accordance with section 12 of the Licensing Act 2003.

Premises Address

Are you able to provide a postal address, OS map reference or description of the premises?

☒ Address ☐ OS map reference ☐ Description

*Continued from previous page...***Address**

Building number or name	MARTINS
Street	5 The Vineyards
District	
City or town	Great Baddow
County or administrative area	CHELMSFORD
Postcode	CM2 7QS
Country	United Kingdom

Contact Details

E-mail	
Telephone number	
Fax number	
Other telephone number	
Non-domestic rateable value of premises (£)	37,750

Section 3 of 21**APPLICATION DETAILS**

In what capacity are you applying for the premises licence?

- ☐ An individual or individuals
- ☒ A limited company / limited liability partnership
- ☐ A partnership (other than limited liability)
- ☐ An unincorporated association
- ☐ Other (for example a statutory corporation)
- ☐ A recognised club
- ☐ A charity
- ☐ The proprietor of an educational establishment
- ☐ A health service body
- ☐ A person who is registered under part 2 of the Care Standards Act 2000 (c14) in respect of an independent hospital in Wales
- ☐ A person who is registered under Chapter 2 of Part 1 of the Health and Social Care Act 2008 in respect of the carrying on of a regulated activity (within the meaning of that Part) in an independent hospital in England
- ☐ The chief officer of police of a police force in England and Wales

Confirm The Following

- ☒ I am carrying on or proposing to carry on a business which involves the use of the premises for licensable activities
- ☐ I am making the application pursuant to a statutory function
- ☐ I am making the application pursuant to a function discharged by virtue of Her Majesty's prerogative

Section 4 of 21**INDIVIDUAL APPLICANT DETAILS****Name**

Is the name the same as (or similar to) the details given in section one?

☐ Yes

☐ No

If "Yes" is selected you can re-use the details from section one, or amend them as required. Select "No" to enter a completely new set of details.

First name

Family name

Is the applicant 18 years of age or older?

☐ Yes

☐ No

Continued from previous page...

Address

Is the address the same as (or similar to) the address given in section one?

☐ Yes☐ No

If "Yes" is selected you can re-use the details from section one, or amend them as required. Select "No" to enter a completely new set of details.

Building number or name	<input type="text"/>
Street	<input type="text"/>
District	<input type="text"/>
City or town	<input type="text"/>
County or administrative area	<input type="text"/>
Postcode	<input type="text"/>
Country	<input type="text" value="United Kingdom"/>

Contact Details

Are the contact details the same as (or similar to) those given in section one?

☐ Yes☐ No

If "Yes" is selected you can re-use the details from section one, or amend them as required. Select "No" to enter a completely new set of details.

E-mail	<input type="text"/>
Telephone number	<input type="text"/>
Other telephone number	<input type="text"/>
Date of birth	<input type="text"/> / <input type="text"/> / <input type="text"/> dd mm yyyy
Nationality	<input type="text"/>
Right to work share code	<input type="text"/>
	<input type="button" value="Remove this applicant"/>

Documents that demonstrate entitlement to work in the UK

Right to work share code if not submitting scanned documents

Non Individual Applicant's Name

Name	<input type="text" value="ALLIANCE PROPERTY HOLDINGS LIMITED"/>
------	---

Details

Registered number (where applicable)	<input type="text" value="00907499"/>
--------------------------------------	---------------------------------------

Description of applicant (for example partnership, company, unincorporated association etc)

Continued from previous page...

Address

Building number or name	HILMORE HOUSE
Street	GAIN LANE
District	
City or town	BRADFORD
County or administrative area	
Postcode	BD3 7DL
Country	United Kingdom

Contact Details

E-mail		
Telephone number		
Fax number		
Other telephone number		
Date of birth	<input type="text"/> / <input type="text"/> / <input type="text"/> dd mm yyyy	
Nationality	<input type="text"/> <input type="button" value="Remove this applicant"/>	Documents that demonstrate entitlement to work in the UK
<input type="button" value="Add another applicant"/>		

Section 5 of 21**OPERATING SCHEDULE**

When do you want the premises licence to start?	<input type="text"/> / <input type="text"/> / <input type="text"/> dd mm yyyy
If you wish the licence to be valid only for a limited period, when do you want it to end	<input type="text"/> / <input type="text"/> / <input type="text"/> dd mm yyyy

Provide a general description of the premises

For example the type of premises, its general situation and layout and any other information which could be relevant to the licensing objectives. Where your application includes off-supplies of alcohol and you intend to provide a place for consumption of these off- supplies you must include a description of where the place will be and its proximity to the premises.

CONVENIENCE STORE

Continued from previous page...

If 5,000 or more people are expected to attend the premises at any one time, state the number expected to attend

Section 6 of 21**PROVISION OF PLAYS**

See guidance on regulated entertainment

Will you be providing plays?

☐ Yes

☒ No

Standard Days And Timings

MONDAY

Start

End

Start

End

Give timings in 24 hour clock.
(e.g., 16:00) and only give details for the days of the week when you intend the premises to be used for the activity.

TUESDAY

Start

End

Start

End

WEDNESDAY

Start

End

Start

End

THURSDAY

Start

End

Start

End

FRIDAY

Start

End

Start

End

SATURDAY

Start

End

Start

End

SUNDAY

Start

End

Start

End

Will the performance of a play take place indoors or outdoors or both?

☐ Indoors

☐ Outdoors

☐ Both

Where taking place in a building or other structure tick as appropriate. Indoors may include a tent.

Continued from previous page...

State type of activity to be authorised, if not already stated, and give relevant further details, for example (but not exclusively) whether or not music will be amplified or unamplified.

State any seasonal variations for performing plays

For example (but not exclusively) where the activity will occur on additional days during the summer months.

Non standard timings. Where the premises will be used for the performance of a play at different times from those listed in the column on the left, list below

For example (but not exclusively), where you wish the activity to go on longer on a particular day e.g. Christmas Eve.

Section 7 of 21**PROVISION OF FILMS**

See guidance on regulated entertainment

Will you be providing films?

☐ Yes

☒ No

Standard Days And Timings**MONDAY**

Start

End

Start

End

TUESDAY

Start

End

Start

End

WEDNESDAY

Start

End

Start

End

Give timings in 24 hour clock.
(e.g., 16:00) and only give details for the days
of the week when you intend the premises
to be used for the activity.

Continued from previous page...

THURSDAY

Start End Start End

FRIDAY

Start End Start End

SATURDAY

Start End Start End

SUNDAY

Start End Start End

Will the exhibition of films take place indoors or outdoors or both?

☐ Indoors

 ☐ Outdoors

 ☐ Both

Where taking place in a building or other structure tick as appropriate. Indoors may include a tent.

State type of activity to be authorised, if not already stated, and give relevant further details, for example (but not exclusively) whether or not music will be amplified or unamplified.

State any seasonal variations for the exhibition of film

For example (but not exclusively) where the activity will occur on additional days during the summer months.

Non standard timings. Where the premises will be used for the exhibition of film at different times from those listed in the column on the left, list below

For example (but not exclusively), where you wish the activity to go on longer on a particular day e.g. Christmas Eve.

Section 8 of 21**PROVISION OF INDOOR SPORTING EVENTS**

See guidance on regulated entertainment

Continued from previous page...

Will you be providing indoor sporting events?

☐ Yes

☒ No

Standard Days And Timings

MONDAY

Start

End

Start

End

Give timings in 24 hour clock.
(e.g., 16:00) and only give details for the days
of the week when you intend the premises
to be used for the activity.

TUESDAY

Start

End

Start

End

WEDNESDAY

Start

End

Start

End

THURSDAY

Start

End

Start

End

FRIDAY

Start

End

Start

End

SATURDAY

Start

End

Start

End

SUNDAY

Start

End

Start

End

State type of activity to be authorised, if not already stated, and give relevant further details, for example (but not exclusively) whether or not music will be amplified or unamplified.

State any seasonal variations for indoor sporting events

For example (but not exclusively) where the activity will occur on additional days during the summer months.

Continued from previous page...

Non-standard timings. Where the premises will be used for indoor sporting events at different times from those listed in the column on the left, list below

For example (but not exclusively), where you wish the activity to go on longer on a particular day e.g. Christmas Eve.

Section 9 of 21**PROVISION OF BOXING OR WRESTLING ENTERTAINMENTS**

See guidance on regulated entertainment

Will you be providing boxing or wrestling entertainments?

☐ Yes

☒ No

Standard Days And Timings**MONDAY**

Start

End

Start

End

Give timings in 24 hour clock.
(e.g., 16:00) and only give details for the days
of the week when you intend the premises
to be used for the activity.

TUESDAY

Start

End

Start

End

WEDNESDAY

Start

End

Start

End

THURSDAY

Start

End

Start

End

FRIDAY

Start

End

Start

End

SATURDAY

Start

End

Start

End

Continued from previous page...

SUNDAY

Start End Start End

Will the boxing or wrestling entertainment take place indoors or outdoors or both?

☐ Indoors☐ Outdoors☐ Both

Where taking place in a building or other structure tick as appropriate. Indoors may include a tent.

State type of activity to be authorised, if not already stated, and give relevant further details, for example (but not exclusively) whether or not music will be amplified or unamplified.

State any seasonal variations for boxing and wrestling entertainment

For example (but not exclusively) where the activity will occur on additional days during the summer months.

Non-standard timings. Where the premises will be used for the boxing or wrestling entertainment at different times from those listed in the column on the left, list below

For example (but not exclusively), where you wish the activity to go on longer on a particular day e.g. Christmas Eve.

Section 10 of 21**PROVISION OF LIVE MUSIC**

See guidance on regulated entertainment

Will you be providing live music?

☐ Yes☒ No**Standard Days And Timings**

MONDAY

Start End Start End

Give timings in 24 hour clock.
(e.g., 16:00) and only give details for the days
of the week when you intend the premises
to be used for the activity.

TUESDAY

Start End Start End

Continued from previous page...

WEDNESDAY

Start End Start End

THURSDAY

Start End Start End

FRIDAY

Start End Start End

SATURDAY

Start End Start End

SUNDAY

Start End Start End

Will the performance of live music take place indoors or outdoors or both?

☐ Indoors☐ Outdoors☐ Both

Where taking place in a building or other structure tick as appropriate. Indoors may include a tent.

State type of activity to be authorised, if not already stated, and give relevant further details, for example (but not exclusively) whether or not music will be amplified or unamplified.

State any seasonal variations for the performance of live music

For example (but not exclusively) where the activity will occur on additional days during the summer months.

Non-standard timings. Where the premises will be used for the performance of live music at different times from those listed in the column on the left, list below

For example (but not exclusively), where you wish the activity to go on longer on a particular day e.g. Christmas Eve.

Continued from previous page...

Section 11 of 21

PROVISION OF RECORDED MUSIC

See guidance on regulated entertainment

Will you be providing recorded music?

☐ Yes☒ No

Standard Days And Timings

MONDAY

Start End Start End

Give timings in 24 hour clock.
(e.g., 16:00) and only give details for the days
of the week when you intend the premises
to be used for the activity.

TUESDAY

Start End Start End

WEDNESDAY

Start End Start End

THURSDAY

Start End Start End

FRIDAY

Start End Start End

SATURDAY

Start End Start End

SUNDAY

Start End Start End

Will the playing of recorded music take place indoors or outdoors or both?

☐ Indoors☐ Outdoors☐ Both

Where taking place in a building or other
structure tick as appropriate. Indoors may
include a tent.

State type of activity to be authorised, if not already stated, and give relevant further details, for example (but not exclusively) whether or not music will be amplified or unamplified.

Continued from previous page...

State any seasonal variations for playing recorded music

For example (but not exclusively) where the activity will occur on additional days during the summer months.

Non-standard timings. Where the premises will be used for the playing of recorded music at different times from those listed in the column on the left, list below

For example (but not exclusively), where you wish the activity to go on longer on a particular day e.g. Christmas Eve.

Section 12 of 21**PROVISION OF PERFORMANCES OF DANCE**

See guidance on regulated entertainment

Will you be providing performances of dance?

☐ Yes☒ No**Standard Days And Timings****MONDAY**Start End Start End Give timings in 24 hour clock.
(e.g., 16:00) and only give details for the days
of the week when you intend the premises
to be used for the activity.**TUESDAY**Start End Start End **WEDNESDAY**Start End Start End **THURSDAY**Start End Start End **FRIDAY**Start End Start End

Continued from previous page...

SATURDAY

Start End Start End

SUNDAY

Start End Start End

Will the performance of dance take place indoors or outdoors or both?

☐ Indoors☐ Outdoors☐ Both

Where taking place in a building or other structure tick as appropriate. Indoors may include a tent.

State type of activity to be authorised, if not already stated, and give relevant further details, for example (but not exclusively) whether or not music will be amplified or unamplified.

State any seasonal variations for the performance of dance

For example (but not exclusively) where the activity will occur on additional days during the summer months.

Non-standard timings. Where the premises will be used for the performance of dance at different times from those listed in the column on the left, list below

For example (but not exclusively), where you wish the activity to go on longer on a particular day e.g. Christmas Eve.

Section 13 of 21**PROVISION OF ANYTHING OF A SIMILAR DESCRIPTION TO LIVE MUSIC, RECORDED MUSIC OR PERFORMANCES OF DANCE**

See guidance on regulated entertainment

Will you be providing anything similar to live music, recorded music or performances of dance?

☐ Yes☒ No**Standard Days And Timings**

MONDAY

Start End Start End Give timings in 24 hour clock.
(e.g., 16:00) and only give details for the days
of the week when you intend the premises
to be used for the activity.

Continued from previous page...

TUESDAY

Start End Start End

WEDNESDAY

Start End Start End

THURSDAY

Start End Start End

FRIDAY

Start End Start End

SATURDAY

Start End Start End

SUNDAY

Start End Start End

Give a description of the type of entertainment that will be provided

Will this entertainment take place indoors or outdoors or both?

☐ Indoors

 ☐ Outdoors

 ☐ Both

Where taking place in a building or other structure tick as appropriate. Indoors may include a tent.

State type of activity to be authorised, if not already stated, and give relevant further details, for example (but not exclusively) whether or not music will be amplified or unamplified.

State any seasonal variations for entertainment

For example (but not exclusively) where the activity will occur on additional days during the summer months.

Continued from previous page...

Non-standard timings. Where the premises will be used for entertainment at different times from those listed in the column on the left, list below

For example (but not exclusively), where you wish the activity to go on longer on a particular day e.g. Christmas Eve.

Section 14 of 21**LATE NIGHT REFRESHMENT**

Will you be providing late night refreshment?

☐ Yes

☒ No
Standard Days And Timings

MONDAY

Start End Start End

Give timings in 24 hour clock.
(e.g., 16:00) and only give details for the days
of the week when you intend the premises
to be used for the activity.

TUESDAY

Start End Start End

WEDNESDAY

Start End Start End

THURSDAY

Start End Start End

FRIDAY

Start End Start End

SATURDAY

Start End Start End

SUNDAY

Start End Start End

Continued from previous page...

Will the provision of late night refreshment take place indoors or outdoors or both?

☐ Indoors

☐ Outdoors

☐ Both

Where taking place in a building or other structure tick as appropriate. Indoors may include a tent.

State type of activity to be authorised, if not already stated, and give relevant further details, for example (but not exclusively) whether or not music will be amplified or unamplified.

State any seasonal variations

For example (but not exclusively) where the activity will occur on additional days during the summer months.

Non-standard timings. Where the premises will be used for the supply of late night refreshments at different times from those listed in the column on the left, list below

For example (but not exclusively), where you wish the activity to go on longer on a particular day e.g. Christmas Eve.

Section 15 of 21

SUPPLY OF ALCOHOL

Will you be selling or supplying alcohol?

☒ Yes

☐ No

Standard Days And Timings

MONDAY

Start

End

Start

End

Give timings in 24 hour clock.
(e.g., 16:00) and only give details for the days
of the week when you intend the premises
to be used for the activity.

TUESDAY

Start

End

Start

End

Continued from previous page...

WEDNESDAY

Start 06:00

End 23:00

Start

End

THURSDAY

Start 06:00

End 23:00

Start

End

FRIDAY

Start 06:00

End 23:00

Start

End

SATURDAY

Start 06:00

End 23:00

Start

End

SUNDAY

Start 06:00

End 23:00

Start

End

Will the sale of alcohol be for consumption:

☐ On the premises
 ☒ Off the premises
 ☐ Both

If the sale of alcohol is for consumption on the premises select on, if the sale of alcohol is for consumption away from the premises select off. If the sale of alcohol is for consumption on the premises and away from the premises select both.

State any seasonal variations

For example (but not exclusively) where the activity will occur on additional days during the summer months.

Non-standard timings. Where the premises will be used for the supply of alcohol at different times from those listed in the column on the left, list below

For example (but not exclusively), where you wish the activity to go on longer on a particular day e.g. Christmas Eve.

State the name and details of the individual whom you wish to specify on the licence as premises supervisor

Continued from previous page...

Name

First name

Family name

Date of birth

 / /
 dd mm yyyy
Address

Building number or name

Street

District

City or town

County or administrative area

Postcode

Country

Personal Licence number
(if known)Issuing licensing authority
(if known)**PROPOSED DESIGNATED PREMISES SUPERVISOR CONSENT**

How will the consent form of the proposed designated premises supervisor be supplied to the authority?

☐ Electronically, by the proposed designated premises supervisor☒ As an attachment to this application

Reference number for consent form (if known)

If the consent form is already submitted, ask the proposed designated premises supervisor for its 'system reference' or 'your reference'.

Section 16 of 21**ADULT ENTERTAINMENT**

Highlight any adult entertainment or services, activities, or other entertainment or matters ancillary to the use of the premises that may give rise to concern in respect of children

Give information about anything intended to occur at the premises or ancillary to the use of the premises which may give rise to concern in respect of children, regardless of whether you intend children to have access to the premises, for example (but not exclusively) nudity or semi-nudity, films for restricted age groups etc gambling machines etc.

NONE

Continued from previous page...

Section 17 of 21

HOURS PREMISES ARE OPEN TO THE PUBLIC

Standard Days And Timings

MONDAY

Start End Start End

Give timings in 24 hour clock.
(e.g., 16:00) and only give details for the days
of the week when you intend the premises
to be used for the activity.

TUESDAY

Start End Start End

WEDNESDAY

Start End Start End

THURSDAY

Start End Start End

FRIDAY

Start End Start End

SATURDAY

Start End Start End

SUNDAY

Start End Start End

State any seasonal variations

For example (but not exclusively) where the activity will occur on additional days during the summer months.

Non standard timings. Where you intend to use the premises to be open to the members and guests at different times from those listed in the column on the left, list below

For example (but not exclusively), where you wish the activity to go on longer on a particular day e.g. Christmas Eve.

Continued from previous page...

Section 18 of 21

LICENSING OBJECTIVES

Describe the steps you intend to take to promote the four licensing objectives:

a) General – all four licensing objectives (b,c,d,e)

List here steps you will take to promote all four licensing objectives together.

PLEASE SEE CONDITIONS ATTACHED

b) The prevention of crime and disorder

PLEASE SEE CONDITIONS ATTACHED

c) Public safety

PLEASE SEE CONDITIONS ATTACHED

d) The prevention of public nuisance

PLEASE SEE CONDITIONS ATTACHED

e) The protection of children from harm

PLEASE SEE CONDITIONS ATTACHED

Section 19 of 21

NOTES ON DEMONSTRATING ENTITLEMENT TO WORK IN THE UK

Continued from previous page...

Entitlement to work/immigration status for individual applicants and applications from partnerships which are not limited liability partnerships:

A licence may not be held by an individual or an individual in a partnership who is resident in the UK who:

- does not have the right to live and work in the UK; or
- is subject to a condition preventing him or her from doing work relating to the carrying on of a licensable activity.

Any premises licence issued in respect of an application made on or after 6 April 2017 will become invalid if the holder ceases to be entitled to work in the UK.

Applicants must demonstrate that they have an entitlement to work in the UK and are not subject to a condition preventing them from doing work relating to the carrying on of a licensable activity. They do this in one of two ways: 1) by providing with this application copies or scanned copies of the documents listed below (which do not need to be certified), or 2) by providing their 'share code' to enable the licensing authority to carry out a check using the Home Office online right to work checking service (see below).

Documents which demonstrate entitlement to work in the UK

- An expired or current passport showing the holder, or a person named in the passport as the child of the holder, is A British citizen or a citizen of the UK and Colonies having the right of abode in the UK [please see note below about which sections of the passport to copy].
- An expired or current passport or national identity card showing the holder, or a person named in the passport as the child of the holder, is a national of a European Economic Area country or Switzerland.
- A Registration Certificate or document certifying permanent residence issued by the Home Office to a national of a European Economic Area country or Switzerland.
- A Permanent Residence Card issued by the Home Office to the family member of a national of a European Economic Area country or Switzerland.
- A **current** Biometric Immigration Document (Biometric Residence Permit) issued by the Home Office to the holder indicating that the person named is allowed to stay indefinitely in the UK, or has no time limit on their stay in the UK.
- A **current** passport endorsed to show that the holder is exempt from immigration control, is allowed to stay indefinitely in the UK, has the right of abode in the UK, or has no time limit on their stay in the UK.
- A **current** Immigration Status Document issued by the Home Office to the holder with an endorsement indicating that the named person is allowed to stay indefinitely in the UK or has no time limit on their stay in the UK, **when produced in combination with** an official document giving the person's permanent National Insurance number and their name issued by a Government agency or a previous employer.
- A birth or adoption certificate issued in the UK, **when produced in combination with** an official document giving the person's permanent National Insurance number and their name issued by a Government agency or a previous employer.
- A birth or adoption certificate issued in the Channel Islands, the Isle of Man or Ireland **when produced in combination with** an official document giving the person's permanent National Insurance number and their name issued by a Government agency or a previous employer.
- A certificate of registration or naturalisation as a British citizen, **when produced in combination with** an official document giving the person's permanent National Insurance number and their name issued by a Government agency or a previous employer.

Continued from previous page...

- A **current** passport endorsed to show that the holder is allowed to stay in the UK and is currently allowed to work and is not subject to a condition preventing the holder from doing work relating to the carrying on of a licensable activity.
- A **current** Biometric Immigration Document (Biometric Residence Permit) issued by the Home Office to the holder which indicates that the named person can currently stay in the UK and is allowed to work relation to the carrying on of a licensable activity.
- A **current** Residence Card issued by the Home Office to a person who is not a national of a European Economic Area state or Switzerland but who is a family member of such a national or who has derivative rights or residence.
- A **current** Immigration Status Document containing a photograph issued by the Home Office to the holder with an endorsement indicating that the named person may stay in the UK, and is allowed to work and is not subject to a condition preventing the holder from doing work relating to the carrying on of a licensable activity **when produced in combination with** an official document giving the person's permanent National Insurance number and their name issued by a Government agency or a previous employer.
- A Certificate of Application, **less than 6 months old**, issued by the Home Office under regulation 18(3) or 20(2) of the Immigration (European Economic Area) Regulations 2016, to a person who is not a national of a European Economic Area state or Switzerland but who is a family member of such a national or who has derivative rights of residence.
- Reasonable evidence that the person has an outstanding application to vary their permission to be in the UK with the Home Office such as the Home Office acknowledgement letter or proof of postage evidence, or reasonable evidence that the person has an appeal or administrative review pending on an immigration decision, such as an appeal or administrative review reference number.
- Reasonable evidence that a person who is not a national of a European Economic Area state or Switzerland but who is a family member of such a national or who has derivative rights of residence in exercising treaty rights in the UK including:-
 - evidence of the applicant's own identity – such as a passport,
 - evidence of their relationship with the European Economic Area family member – e.g. a marriage certificate, civil partnership certificate or birth certificate, and
 - evidence that the European Economic Area national has a right of permanent residence in the UK or is one of the following if they have been in the UK for more than 3 months:
 - (i) working e.g. employment contract, wage slips, letter from the employer,
 - (ii) self-employed e.g. contracts, invoices, or audited accounts with a bank,
 - (iii) studying e.g. letter from the school, college or university and evidence of sufficient funds; or
 - (iv) self-sufficient e.g. bank statements.

Family members of European Economic Area nationals who are studying or financially independent must also provide evidence that the European Economic Area national and any family members hold comprehensive sickness insurance in the UK. This can include a private medical insurance policy, an EHIC card or an S1, S2 or S3 form.

Original documents must not be sent to licensing authorities. If the document copied is a passport, a copy of the following pages should be provided:-

- (i) any page containing the holder's personal details including nationality;
- (ii) any page containing the holder's photograph;
- (iii) any page containing the holder's signature;
- (iv) any page containing the date of expiry; and
- (v) any page containing information indicating the holder has permission to enter or remain in the UK and is permitted to work.

Continued from previous page...

If the document is not a passport, a copy of the whole document should be provided.

Your right to work will be checked as part of your licensing application and this could involve us checking your immigration status with the Home Office. We may otherwise share information with the Home Office. Your licence application will not be determined until you have complied with this guidance.

Home Office online right to work checking service

As an alternative to providing a copy of the documents listed above, applicants may demonstrate their right to work by allowing the licensing authority to carry out a check with the Home Office online right to work checking service.

To demonstrate their right to work via the Home Office online right to work checking service, applicants should include in this application their 9-digit share code (provided to them upon accessing the service at <https://www.gov.uk/prove-right-to-work>) which, along with the applicant's date of birth (provided within this application), will allow the licensing authority to carry out the check.

In order to establish the applicant's right to work, the check will need to indicate that the applicant is allowed to work in the United Kingdom and is not subject to a condition preventing them from doing work relating to the carrying on of a licensable activity.

An online check will not be possible in all circumstances because not all applicants will have an immigration status that can be checked online. The Home Office online right to work checking service sets out what information and/or documentation applicants will need in order to access the service. Applicants who are unable to obtain a share code from the service should submit copy documents as set out above.

Section 20 of 21**NOTES ON REGULATED ENTERTAINMENT**

Continued from previous page...

In terms of specific **regulated entertainments** please note that:

- Plays: no licence is required for performances between 08:00 and 23.00 on any day, provided that the audience does not exceed 500.
- Films: no licence is required for 'not-for-profit' film exhibition held in community premises between 08.00 and 23.00 on any day provided that the audience does not exceed 500 and the organiser (a) gets consent to the screening from a person who is responsible for the premises; and (b) ensures that each such screening abides by age classification ratings.
- Indoor sporting events: no licence is required for performances between 08.00 and 23.00 on any day, provided that the audience does not exceed 1000.
- Boxing or Wrestling Entertainment: no licence is required for a contest, exhibition or display of Greco-Roman wrestling, or freestyle wrestling between 08.00 and 23.00 on any day, provided that the audience does not exceed 1000. Combined fighting sports – defined as a contest, exhibition or display which combines boxing or wrestling with one or more martial arts – are licensable as a boxing or wrestling entertainment rather than an indoor sporting event.
- Live music: no licence permission is required for:
 - o a performance of unamplified live music between 08.00 and 23.00 on any day, on any premises.
 - o a performance of amplified live music between 08.00 and 23.00 on any day on premises authorised to sell alcohol for consumption on those premises, provided that the audience does not exceed 500.
 - o a performance of amplified live music between 08.00 and 23.00 on any day, in a workplace that is not licensed to sell alcohol on those premises, provided that the audience does not exceed 500.
 - o a performance of amplified live music between 08.00 and 23.00 on any day, in a church hall, village hall, community hall, or other similar community premises, that is not licensed by a premises licence to sell alcohol, provided that (a) the audience does not exceed 500, and (b) the organiser gets consent for the performance from a person who is responsible for the premises.
 - o a performance of amplified live music between 08.00 and 23.00 on any day, at the non-residential premises of (i) a local authority, or (ii) a school, or (iii) a hospital, provided that (a) the audience does not exceed 500, and (b) the organiser gets consent for the performance on the relevant premises from: (i) the local authority concerned, or (ii) the school or (iii) the health care provider for the hospital.
- Recorded Music: no licence permission is required for:
 - o any playing of recorded music between 08.00 and 23.00 on any day on premises authorised to sell alcohol for consumption on those premises, provided that the audience does not exceed 500.
 - o any playing of recorded music between 08.00 and 23.00 on any day, in a church hall, village hall, community hall, or other similar community premises, that is not licensed by a premises licence to sell alcohol, provided that (a) the audience does not exceed 500, and (b) the organiser gets consent for the performance from a person who is responsible for the premises.
 - o any playing of recorded music between 08.00 and 23.00 on any day, at the non-residential premises of (i) a local authority, or (ii) a school, or (iii) a hospital, provided that (a) the audience does not exceed 500, and (b) the organiser gets consent for the performance on the relevant premises from: (i) the local authority concerned, or (ii) the school proprietor or (iii) the health care provider for the hospital.

Continued from previous page...

- Dance: no licence is required for performances between 08.00 and 23.00 on any day, provided that the audience does not exceed 500. However, a performance which amounts to adult entertainment remains licensable.
- Cross activity exemptions: no licence is required between 08.00 and 23.00 on any day, with no limit on audience size for:
 - o any entertainment taking place on the premises of the local authority where the entertainment is provided by or on behalf of the local authority;
 - o any entertainment taking place on the hospital premises of the health care provider where the entertainment is provided by or on behalf of the health care provider;
 - o any entertainment taking place on the premises of the school where the entertainment is provided by or on behalf of the school proprietor; and
 - o any entertainment (excluding films and a boxing or wrestling entertainment) taking place at a travelling circus, provided that (a) it takes place within a moveable structure that accommodates the audience, and (b) that the travelling circus has not been located on the same site for more than 28 consecutive days.

Section 21 of 21**PAYMENT DETAILS**

This fee must be paid to the authority. If you complete the application online, you must pay it by debit or credit card.

Fee amount (£)

315.00

ATTACHMENTS**AUTHORITY POSTAL ADDRESS****Address**

Building number or name

Street

District

City or town

County or administrative area

Postcode

Country

United Kingdom

DECLARATION

This section should be completed by the applicant, unless you answered "Yes" to the question "Are you an agent acting on behalf of the applicant?"

Full name

Capacity

Date

dd / mm / yyyy

Remove this signatory

Continued from previous page...

Add another signatory

Once you're finished you need to do the following:

1. Save this form to your computer by clicking file/save as...

2. Go back to <https://www.chelmsford.gov.uk/business/licensing/alcohol-licensing/premises-licence/apply-for-a-new-premises-licence/> to upload this file and continue with your application.

Don't forget to make sure you have all your supporting documentation to hand.

IT IS AN OFFENCE LIABLE TO SUMMARY CONVICTION TO A FINE OF ANY AMOUNT UNDER SECTION 158 OF THE LICENSING ACT 2003, TO MAKE A FALSE STATEMENT IN OR IN CONNECTION WITH THIS APPLICATION

IT IS AN OFFENCE UNDER SECTION 24B OF THE IMMIGRATION ACT 1971 FOR A PERSON TO WORK WHEN THEY KNOW, OR HAVE REASONABLE CAUSE TO BELIEVE, THAT THEY ARE DISQUALIFIED FROM DOING SO BY REASON OF THEIR IMMIGRATION STATUS. THOSE WHO EMPLOY AN ADULT WITHOUT LEAVE OR WHO IS SUBJECT TO CONDITIONS AS TO EMPLOYMENT WILL BE LIABLE TO A CIVIL PENALTY UNDER SECTION 15 OF THE IMMIGRATION, ASYLUM AND NATIONALITY ACT 2006 AND PURSUANT TO SECTION 21 OF THE SAME ACT, WILL BE COMMITTING AN OFFENCE WHERE THEY DO SO IN THE KNOWLEDGE, OR WITH REASONABLE CAUSE TO BELIEVE, THAT THE EMPLOYEE IS DISQUALIFIED

OFFICE USE ONLY

Applicant reference number	ARG/LBM/125106.1387
Fee paid	
Payment provider reference	
ELMS Payment Reference	
Payment status	
Payment authorisation code	
Payment authorisation date	
Date and time submitted	
Approval deadline	
Error message	
Is Digitally signed	<input type="checkbox"/>

Digital Signature Information

Signer's name	
Signer's contact information	
Signing time	
Signer status	
Signature status	
Certificate issuer	

< Previous [1](#) [2](#) [3](#) [4](#) [5](#) [6](#) [7](#) [8](#) [9](#) [10](#) [11](#) [12](#) [13](#) [14](#) [15](#) [16](#) [17](#) [18](#) [19](#) [20](#) [21](#) Next >

A comprehensive CCTV system shall be provided on the premises and shall be kept in good working order with footage provided to any responsible authority within a reasonable time on request.

All staff engaged in the sale of alcohol will receive suitable training (including refresher training) in relation to the proof of age "Challenge 25" scheme to be applied on the premises in accordance with the premises licence holder's training procedures. The following forms of identification are acceptable: photo driving licence, passport, proof of age standards scheme (PASS) card and Military ID and any other locally or nationally approved form of identification.

All checkout operators will operate an electronic refusal log.

Till prompts for alcohol products are in use at the store.

Representations received in relation to a New Premises Licence for Martins, 5 The Vineyards, Great Baddow, Chelmsford, Essex, CM2 7QS

Representation 1

Sent: Wednesday, October 25, 2023 8:50 PM

To: Licensing <Licensing@chelmsford.gov.uk>

Subject: Proposed alcohol licence Martins, The Vineyards, Great Baddow

25th October 2023

To: the Licensing Team

As longstanding residents of Great Baddow, we object to the proposed licence for Martins, 5 The Vineyards, Great Baddow, to supply alcohol on Mondays to Sundays between the hours of 6am until 11pm. In other words, 17 hours each day throughout the year!

There are already two public houses and one shop in the vicinity of The Vineyards, and one supermarket in The Vineyards selling alcohol. Therefore, we consider this application to be unnecessary and we are concerned about antisocial behaviour resulting from the availability of alcohol during these extensive hours.

Representation 2

From: Clare Milligan <clerk@greatbaddowparishcouncil.gov.uk>

Sent: Thursday, October 26, 2023 4:39 PM

To: Licensing <Licensing@chelmsford.gov.uk>

Subject: RE: Web contact form submitted ref CFLC 29713

Good Afternoon

I am writing on behalf of Great Baddow Parish Council in relation to the licensing application for Martins, 5 The Vineyards, Great Baddow, Chelmsford, Essex, CM2 7QS.

The Council objects to this licence under the 'prevention of public nuisance' objective and asks for the closing time to be 22:00hr/10pm for the store.

Allowing this store to remain open selling alcohol in a very built-up residential area until 11pm will have the potential to cause a public nuisance by possible unacceptable noise pollution.

Kind regards

Clare

Mrs Clare Milligan

Clerk to the Council

Great Baddow Parish Council

The Parish Hall

19 Maldon Road

Great Baddow

Chelmsford

Essex

CM2 7DW

01245 472967

07955 787368

From: Licensing Chelmsford and Maldon <licensing.chelmsford.and.maldon@essex.police.uk>
Sent: Friday, October 20, 2023 10:43 AM
To: Licensing <Licensing@chelmsford.gov.uk>
Subject: Premises Licence - Martins , 5 The Vine Yards

Good morning ,

I have been negotiations with the applicants representative and the following conditions have been agreed – If these can be added to the premises licence Essex Police have no further representations. I have added the email chain for confirmation.

1 - The premises shall have installed and maintain a closed circuit television surveillance (CCTV) system that at all times complies with the below requirements:

- i. During the hours of licensable activities, CCTV will be provided in the form of a recordable system, capable of providing pictures of evidential quality in all lighting conditions particularly facial recognition;*
- ii. CCTV cameras shall cover all public areas including where the sale of alcohol takes place;*
- iii. Equipment must be maintained in good working order, be correctly time and date stamped, recordings must be kept in good working order and kept for a minimum period of {31} days;*
- iv. At all times, whilst the premises is open for licensable activities, there are members of staff able to request viewable copies of recordings from the premises licence holder's IT Dept to be urgently provided for the police or licensing authority staff upon reasonable request*
- v. The recording equipment and data storage devices shall be kept in a secure environment and fitted with security functions (such as passwords) to prevent recordings being tampered with; Any faults/defects in the CCTV system will be remedied as soon as reasonably possible*

2 - Signs must be displayed at all entrances {and exits} advising customers that CCTV is operating at the premises and shall be a minimum size of 200 x 148 mm and clearly legible at all times when the premises conducts licensable activities.

3 - No single cans of beer or cider with an ABV of over 6.5% to be offered for sale at the premises

4 - A Challenge 25 scheme shall be operated, whereby any person who appears to be under the age of 25 years of age is required to produce on request an item which meets the mandatory age verification requirement (photo, name, date of birth and either a holographic mark or ultraviolet feature) and is either a:

- Proof of age card bearing the PASS Hologram;*
- Photocard driving licence;*
- Passport*
- Ministry of Defence Identity Card.*
- Biometric Residence Permit*
- National ID issued by an EU country.*

5 - The premises shall clearly display signs at the each point of sale and in areas where alcohol is displayed advising customers that a 'Challenge 25' policy is in force.

At the point of sale, such signs shall be a minimum size of 200mm x 148mm.



Essex Stays at
The Kings Head

RSPCA Essex Mid
& North Branch

Vogue Hair Design

TOP CLASS DE JAVU

Acacia Beauty
& Aesthetics

Co-op Food -
Great Baddow
Community Store

Ottavia House Schools
Essex - Great Baddow

Rothmans Bed
& Breakfast
4.0 3-star hotel

Great Baddow Library

The Causeway

Vineyards Lodge
The Causeway

St Mary's C of E Church

Aaron Crowe
Photography + Video

Page 43 of 44

The Reading Rooms

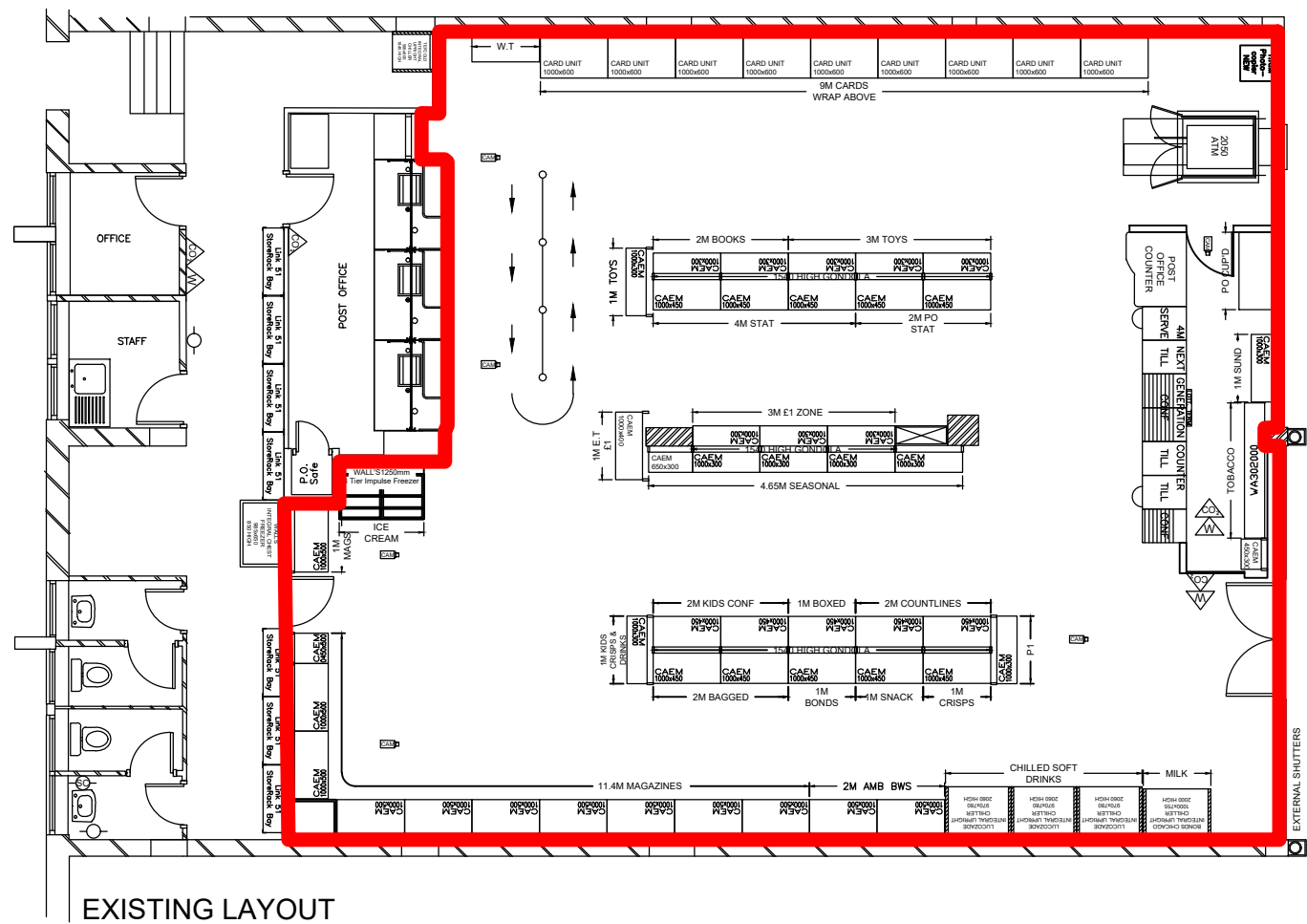

EXISTING LAYOUT

- FIRE SIGNAGE:
- EMERGENCY LIGHTING
 - FIRE EXIT SIGNS
 - FIRE EXIT SIGN WITH DIRECTIONAL ARROW
 - FIRE EXIT SIGN WITH RUNNING MAN
 - FIRE EXTINGUISHER - WATER
 - FIRE EXTINGUISHER - CO2
 - FIRE EXTINGUISHER - FOAM
 - FIRE BELL/SOUNDER
 - SMOKE DETECTOR
 - BREAK GLASS POINT
 - F.P. FIRE ALARM PANEL
 - F.D. FIRE DOOR
 - F.A. FIRE ACTION SIGNAGE
 - SECURITY CAMERA
- (FIRE EXTINGUISHER SIGNAGE TO BE PROVIDED AT EACH LOCATION)

- NOTES:
- FIRE FIGHTING EQUIPMENT & ALL OF THE REQUIREMENTS OF THE FIRE SERVICE WILL BE INCORPORATED & WILL BE PROVIDED TO COMPLY WITH THE EUROPEAN STANDARDS
 - No. BSEN3 & BS7863.
 - ALL WALL/PERIMETER FIXTURES TO A HEIGHT OF 2.1M
 - ALL FLOOR DISPLAYS TO A HEIGHT OF 1.5M
 - COUNTER HEIGHT 965MM
- FIRE STANDARDS:
- FIRE SAFETY RELATED SIGNS AND NOTICES ARE TO THE HEALTH AND SAFETY (SAFETY SIGNS & SIGNALS) REGULATIONS ACT 1996. THOSE THAT COMPLY TO BS 5499, PART 1, 1990 ALSO COMPLY.
 - ILLUMINATED "EXIT" SIGNS ARE TO CONFORM TO BS2560.
 - FIRE FIGHTING EQUIPMENT IS TO COMPLY WITH EUROPEAN STANDARDS BS EN3 AND BS 7863

GREAT BADDOW THE VINEYARDS

2 The Vineyards, Great Baddow, Essex CM2 7QS

235-SK3-BWSL-001

SALES FLOOR

RETAIL SALES AREA 1859 Sq. Ft.

Scale: 1:100



Wm MORRISON SUPERMARKETS LTD
Property & Development Division
Hillmore House, Gain Lane, Bradford, BD3 7DL
Tel: 0845 611 6000