

SOUTH ESSEX PARKING PARTNERSHIP SUB COMMITTEE

TUESDAY 1st NOVEMBER 2022 – 10.30AM

AGENDA ITEM 9

Subject	The Essex County Council (Maldon District) (Prohibition of Waiting, Loading and Stopping) And (On-Street Parking Places) (Civil Enforcement Area) (Amendment No.7) Order 202* Relating to Park Drive, Maldon
Report by	South Essex Parking Partnership Manager

Enquiries contact:

Nick Binder, South Essex Parking Partnership Manager,
01245 606303, nick.binder@chelmsford.gov.uk

Purpose:

To report the receipt of representations made on part of The Essex County Council (Maldon District) (Prohibition of Waiting, Loading and Stopping) And (On-Street Parking Places) (Civil Enforcement Area) (Amendment No.7) Order 202*

Options

The Joint Committee has the following options available:

1. to agree that the proposed Order be made as advertised.
2. to agree that the proposed Order be made subject to modifications which result in less restrictive provisions or reduced scope.
3. to agree that the proposed Order be withdrawn in its entirety.

Recommendation(s)

1. The proposed Order should be made in part by withdrawing the proposed lengths of 'No Waiting at Any Time' restrictions opposite numbers 2-7, 18-26 and 30-36, with the remaining to be made as advertised (as shown in Appendix 4).
2. The people making representations be advised accordingly.

Consulters

South Essex Parking Partnership

Policies and Strategies

The report takes into account the South Essex Parking Partnership Document setting out how the SEPP will deal with requests for parking restrictions requiring TROs.

1.	Background
1.1	The purpose of this Order is to amend The Essex County Council (Maldon District) (Prohibition of Waiting, Loading and Stopping) and (On-Street Parking Places) (Civil Enforcement Area) Consolidation Order 2019 as set out below:
1.2	In 2019, two application forms were received by SEPP from the Lead Officer for parking matters in Maldon (Maldon District Council).
1.3	The first application form was received 22 May 2019, requesting a Clearway on Park Drive, Maldon to protect grass verges, footways and improve safety from the access to the recycling centre to the Mundon Roundabout. It was outlined by Maldon District Council that parking issues occur on football match days or local events.
1.4	Following the receipt of this, the SEPP carried out a number of site visits. During most of the site visits conducted, there was no evidence of any obstruction or access issues on Park Drive. It was acknowledged however that issues were only likely to occur during large events or match days. It was felt however that due to Park Drive's function within the network, and the potential danger incurred by parking on grass verges, a parking scheme could be justified at this location. As there are bus stops along this section however, double yellow lines were recommended by SEPP Technicians instead of a Clearway. Additionally, vehicles parked on the highway (on footways or grass verges) next to double yellow lines can be issued a penalty charge notice. In addition, double yellow lines are more visible to a driver than a Clearway and therefore would be more effective.
1.5	The second application form was received 2 October 2019, requesting a change to the "seasonal" restrictions on Park Drive 'No Waiting Sat, Sun & Bank Holidays 8am-10pm 1 April to 30 September'. It was stated by Maldon District Council that outside the existing restriction times, vehicles are parking at these sections, causing congestion.
1.6	Following the receipt of this, the SEPP carried out a number of site visits. During most of the site visits conducted, few vehicles were observed as parking on the single yellow lines. During the evenings, generally no vehicles were parked there either. However, these site visits were not conducted during event days. If during events days and weekends all spaces are taken, it is likely that congestion may occur. Therefore, it was recommended by SEPP Technicians that the existing seasonal restrictions be amended to include all year round. Additionally, it was recommended that 'No Waiting at Any Time' restrictions be proposed on junctions of the access roads to the Promenade and the Recycling Centre.
1.7	It was therefore agreed with the Lead Officer and SEPP Joint Committee Member to cost schemes to replace the existing "seasonal" restrictions and implement additional 'No Waiting at Any Time' restrictions ('the Proposal') on Park Drive as recommended. Furthermore, the request for funding was agreed in May 2021 to proceed with the necessary Traffic Regulation Orders on Park Drive, Maldon.
2.	Relevant excerpts from SEPP Policy (Version 6 December 2020)

2.1	SEPP Policy – 1.6 'It is acknowledged that all requests for a parking restriction will carry some form of merit and may be beneficial to the particular area. The requests will be submitted for a variety of reasons and depending on the circumstance will be considered as a high or low funding priority to the Partnership. As the amount of funding available for new schemes is limited it is the intention of this policy to provide a criteria, which if met, will be considered a high priority scheme for the Partnership and therefore stand a greater chance of receiving the available funding. Schemes that do not meet all the criteria can still be progressed and considered by the Joint Committee, but schemes with a higher priority will take precedence. All schemes will be subject to available funding.'
2.2	SEPP Policy – 7.1 'The SEPP will receive all parking restriction requests that do not meet the criteria of ECC safety and congestion policies, detailed above. Although these schemes do not meet the ECC criteria the Partnership may decide to implement parking restrictions to improve safety and sight lines, if the Partnership consider that the restriction will be beneficial to the area.'
3	Traffic Regulation Order
3.1	The proposed Order was published in the Maldon and Burnham Standard and on a public notice erected on the affected parts of Park Drive on 31 March 2022. Copies of the draft Order were sent to a number of organisations including Essex Police, Essex County Council (Essex Highways, the highway authority), Essex Fire & Rescue Service, Essex Ambulance Service, the Road Haulage Association, the Freight Transport Association, and the Chamber of Commerce and Industry
3.2	When the Order was published on 31 March 2022, a 21-day period of formal public consultation commenced.
4	Comments
4.1	The details of the representations are summarised in Appendix 2 to this report together with the comments of the Technicians.
5	Conclusion
5.1	Some correspondents have made several points which lead them to believe 'the Proposal' should not be pursued in whole or part. Therefore, the SEPP Joint Committee Member and Lead Officer for Maldon, and SEPP Technicians recommend that the proposed lengths of 'No Waiting at Any Time' restrictions are withdrawn opposite numbers 2-7, 18-26 and 30-36 Park Drive to allow further parking and the remaining proposed Order be made as advertised (as per Appendix 4).
List of Appendices Appendix 1 – List of people making representations Appendix 2 – Summary of objections or support and Technicians comments Appendix 3 – Photos Appendix 4 – Recommended Parking Restrictions	

APPENDIX 1

Ref	List of people making representations	Type
1	Online submission from resident of Park Drive dated 31/03/2022	Support
2	Email from resident of Park Drive dated 31/03/2022	Support
3	Email from resident of Park Drive dated 08/04/2022	Objection
4	Email from resident of Park Drive dated 20/04/2022	Objection
5	Online submission from local resident of Maldon dated 22/04/2022	Support

APPENDIX 2

**REPRESENTATIONS & RESPONSES FOLLOWING FORMAL ADVERTISEMENT –
31 March 2022 – 22 April 2022**

Representations & responses relating to Park Drive, Maldon		
Ref	Representation -	Technician response -
1	Agree: We live on Park Drive and it is frustrating when vehicles park outside our house.	Support noted.
2	<p>I have been living on Park Drive for [REDACTED] and think your proposals ref SEPP/MAL/AMD7/PARK1 are a very good idea for the reasons you have mentioned. Also when there is a long row of parked cars along Park Drive it effectively makes it single file traffic for a long stretch of road which causes arguments when cars meet in the middle and cars driving on the pavements to pass each other.</p> <p>Please could i suggest some form of enforcement. Currently every year during the seasonal restrictions everyone knows there is no enforcement on a Sunday. So during the summer months every year when football matches are taking place on a Sunday morning there is still a lot of cars parked along Park Drive which is against the restrictions already in place.</p>	<p>Support noted.</p> <p>Regarding the enforcement of current parking restrictions on Sundays, this was reported to the Enforcement Team to investigate.</p> <p>If additional parking restrictions were introduced on Park Drive, these would be incorporated into a route by Civil Enforcement Officers.</p>
3	<p>I write in reference to the proposed changes to Park Drive Maldon.</p> <p>I live at [REDACTED] and while I am all for some kind of restrictions on Park Drive I feel this will just push all the traffic in the roads off Park Drive, including Jersey Road.</p>	<p>Objection noted.</p> <p>It is acknowledged that parking may displace into adjacent roads. It is difficult to determine where this may occur, however if a parking scheme is introduced, its effects would be monitored.</p> <p>The parking charges for the Promenade Park are reviewed by Maldon District Council and set to be comparable with other parks and open</p>

	<p>The side roads are already being used for parking by people visiting The Promenade. I have a drive big enough for two cars, mine and my partners but when we have visitors round they have problems parking near our house already.</p> <p>Summertime is horrendous for parking in the side roads and I feel this could compound the problem for the residents not just on Park Drive but all the roads off it.</p> <p>I feel the bigger picture needs to be looked at when trying to solve the problem of parking down Park Drive - not a traffic issue but the cost of parking at the Promenade is the main reason for levels of on street parking.</p> <p>Just this morning, whilst mowing my front lawn, I watch two cars park on Jersey Road, unload their cars of toys etc for children and head in to the Prom. As mentioned earlier, this time of year is bad but summer time is awful with cars being parked in the side road literally from dawn until dusk.</p>	<p>spaces with similar facilities. The Car Parks in the High Street are a short walk away, which also offers parking to visitors at a rate of £1.50 to park all day on a Sunday and every day after 5pm.</p> <p>Maldon District Council have stated their intention to work with community sports groups who use the park, to look at solutions to reduce the impact of parking within side roads during busy times of the year.</p> <p>Following the comments received, it is being recommended to the Committee that the proposed restrictions on Park Drive be reduced to allow further parking.</p>
4	<p>In response to the parking on park drive maldon. Reference SEPP/MAL/AMD7/PARK1. I think the parking on park drive should stay as it is, having a no parking restriction would only cause vehicles to go faster on this road. As it is I regularly see cars passing my house in excess of 40mph . The best idea in my opinion would be to install a speed camera. Combined with cars parking on the road This would slow traffic right down and make it safer for everyone.</p>	<p>Objection noted.</p> <p>A section on Park Drive between properties 8-16 is being left unrestricted to allow some parking for adjacent residents with limited off-street parking. Additionally, parked vehicles can act as a form of traffic calming.</p> <p>Following the comments received, it is being recommended to the Committee that the proposed restrictions on Park Drive be reduced to allow further parking.</p> <p>Maldon District Council work in Partnership with Essex Police to carry out speed enforcement patrols in Park Drive. Therefore, if any proposal is introduced, vehicle speeds can continue to be monitored.</p> <p>It is beyond the remit of the SEPP to install speed cameras. All other Highway requests should be directed to Essex Highways. It is</p>

		recommended residents contact their local councillor who can address local Highways matters via the Local Highways Panel.
5	<p>Agree: Fully support the proposals - a lot has changed since I amended the existing restrictions several years ago! Can I please ask why there are no restriction outside 8-16 Park Drive?</p> <p>No further response received</p>	<p>Support noted.</p> <p>A section on Park Drive between properties 8-16 is being left unrestricted to allow some parking for adjacent residents with limited off-street parking. Additionally, parked vehicles can act as a form of traffic calming</p> <p>Following the comments received, it is being recommended to the Committee that the proposed restrictions on Park Drive be reduced to allow further parking.</p> <p>The representee was informed that if they desired further restrictions on Park Drive, they should respond accordingly in writing.</p>

APPENDIX 3

Photos

Images of verge parking on Park Drive provided by original applicant in 2019



Image of Park Drive taken by SEPP Technician in 2019, facing north-westwards



APPENDIX 4

Recommended Parking Restrictions

Image 1

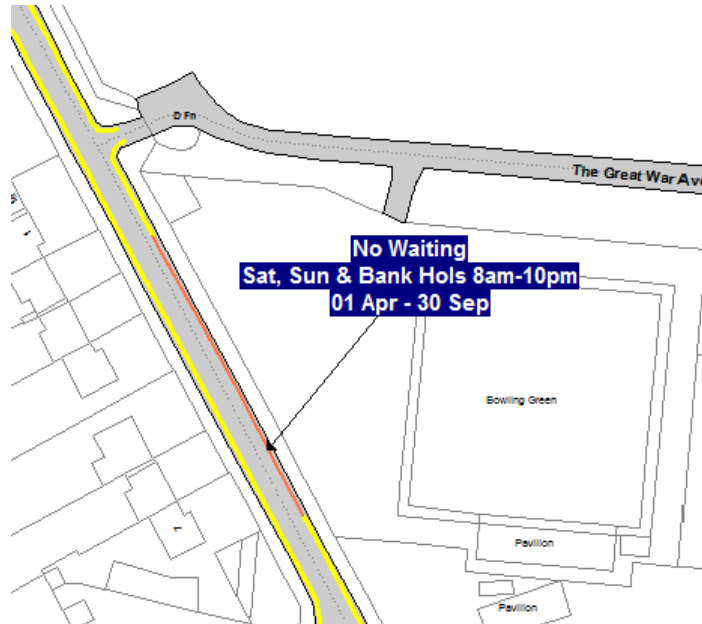

Image 1 – Proposed ‘No Waiting at Any Time’ restrictions opposite 2-7 Park Drive to be withdrawn.

Image 2

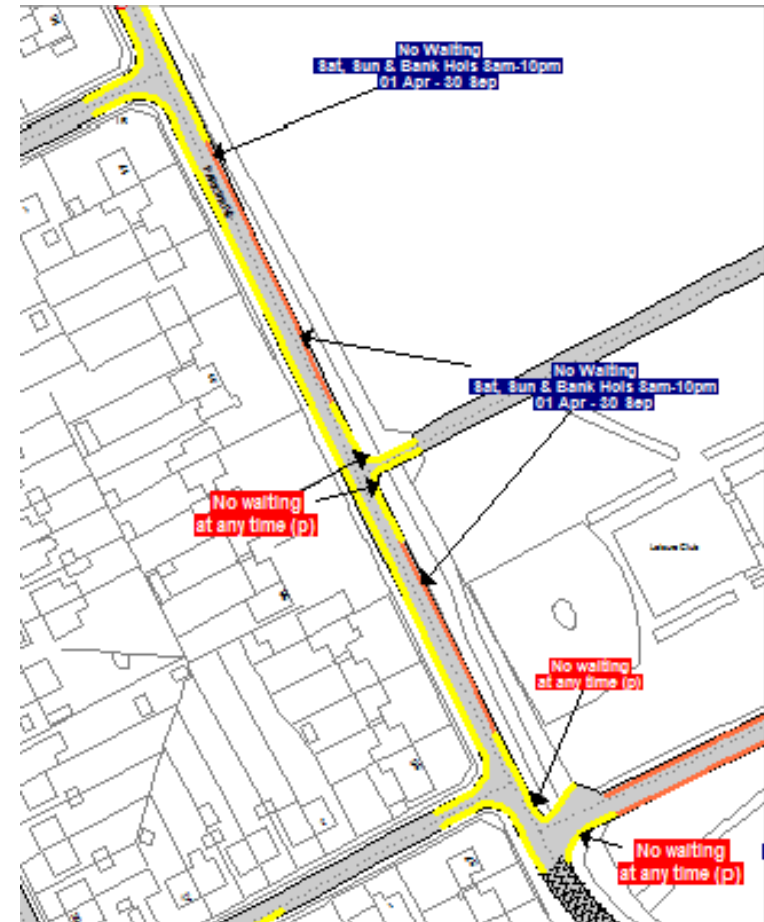

Image 2 - Proposed ‘No Waiting at Any Time’ restrictions opposite 18-26 and 30-36 Park Drive to be withdrawn. Proposed ‘No Waiting at Any Time’ to remain on junctions of Park Drive and access roads to The Promenade and the Recycling Centre as advertised.

Image 3

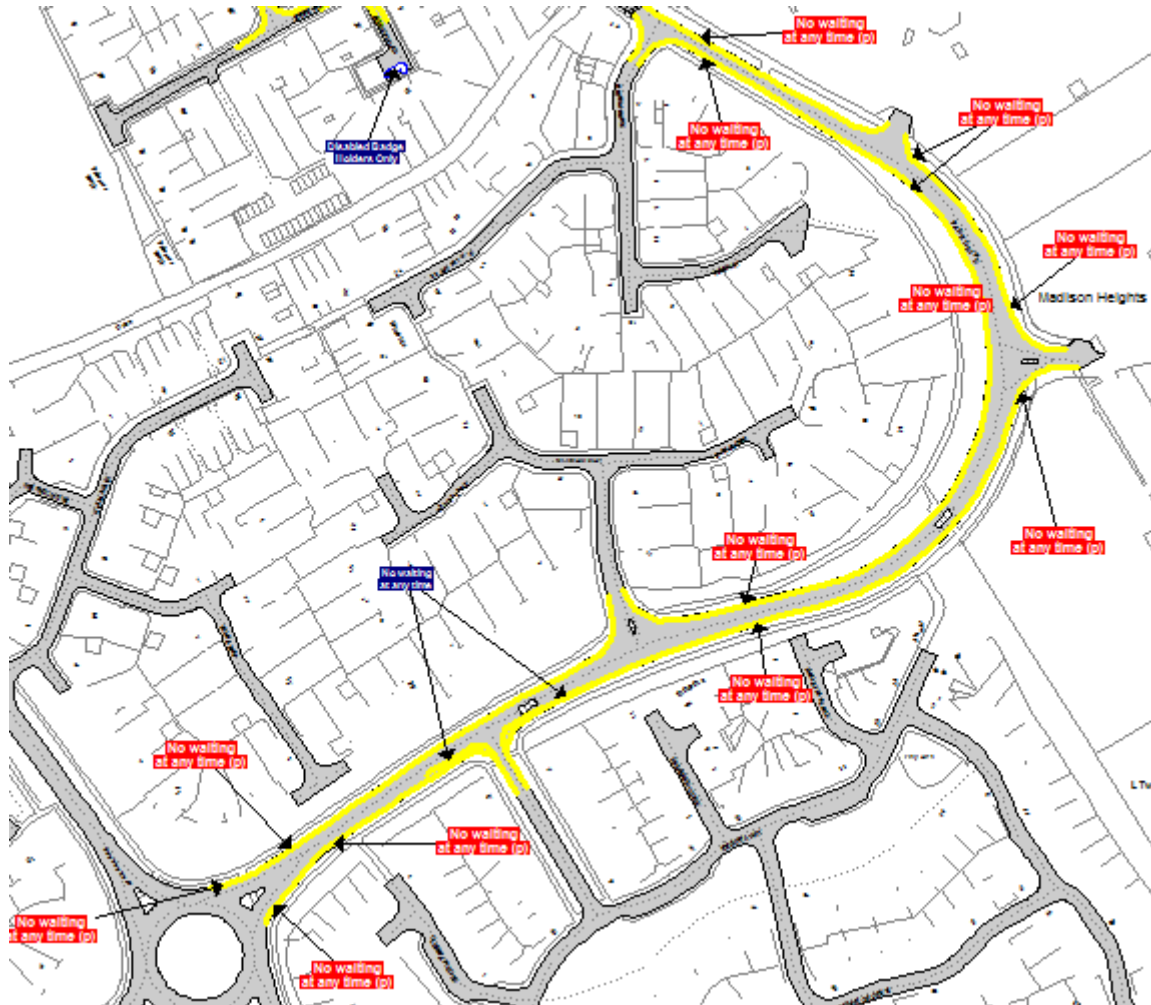

Image 3 – Proposed ‘No Waiting at Any Time’ between Mirosa Drive and Mundon Road roundabout to remain as advertised.