

Welcome to the Museum of Chelmsford

The museum is fully accessible. Please ask a Visitor Host on the Welcome Desk if you have any questions or need any assistance.

Boris Bear sensory bag and ear defenders - ask at the front desk if you would like these while you are in the museum.

I spy picture trails - pick up a sheet, clipboard and pencil from the orange box by the front desk.

Orange 'hands-on' activity stations - look out for the 'orange based exhibits' in the galleries which have things to touch and do.

Touch screen kiosks - you will find these throughout the museum, they have lots of pictures, games and extra information on.

Mannequins and audio-visual presentations - these are marked on the plan so you can easily avoid these galleries if you wish to.



Tudor life room

There is an audio visual with 3 films. They will only play when you press the button. There is a large interactive map in the centre of the room.

Saxon room

There is an illusion film showing an Angle Saxon warrior burial which includes the sound of chanting monks. It is most visible when you sit on the bench.

Roman life room

The ramp in this room has a glass floor over a stone coffin. To avoid this, you can go along the corridor or ask a Visitor Host to cover the glass with a mat if you are unable to go up steps.

Prehistoric room

This room feels cooler. The AV plays on loop with background sound effects.

The Wells Suite

If you are attending an activity, it is most likely in this room.

First Floor

Corridor and landing

Allows you to avoid any rooms. There are three steps here.

Fire exit only

Yeomanry Display

This corridor has mannequins and dim lighting.

Essex Regiment Museum

This room has mannequins and dim lighting.

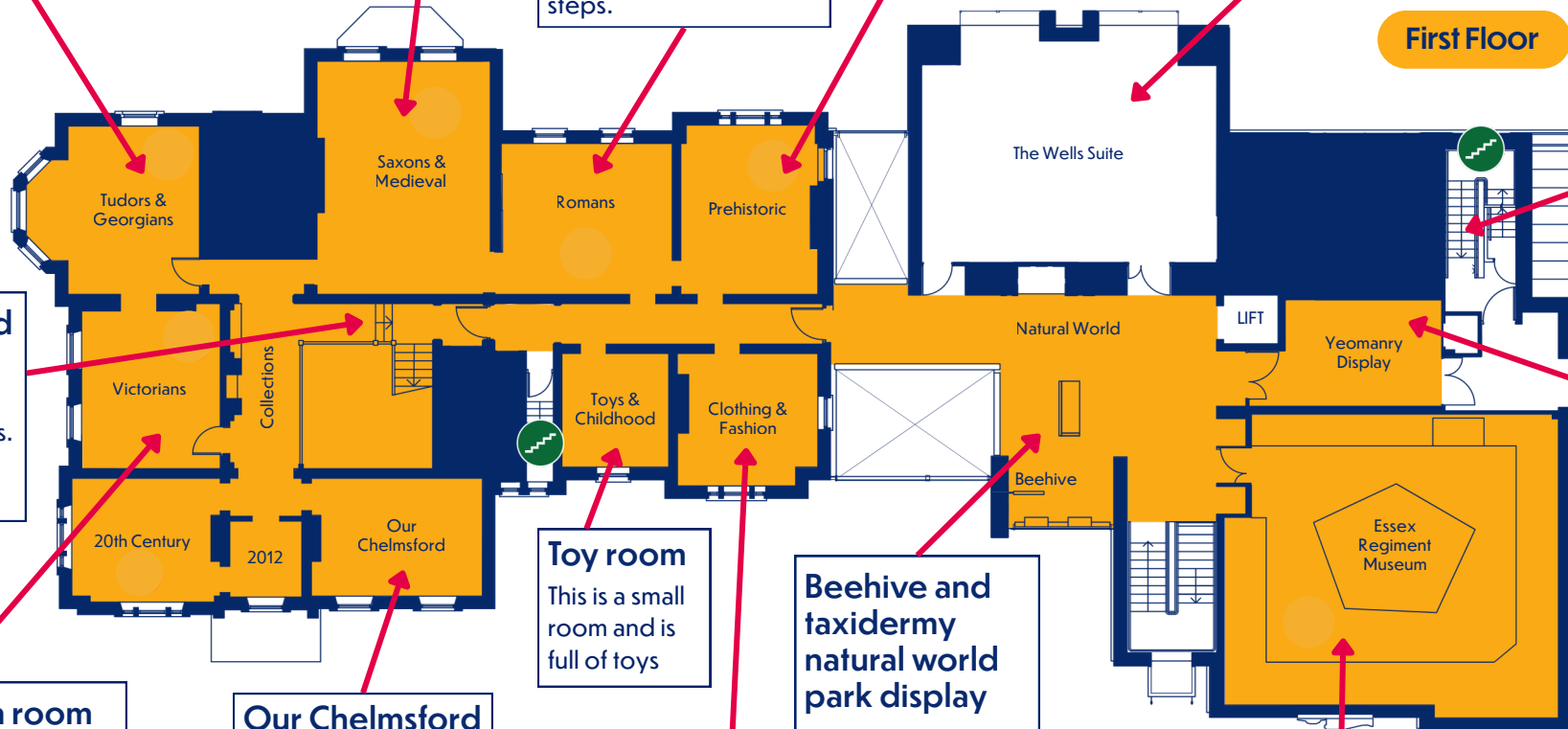

Toy room

This is a small room and is full of toys

Beehive and taxidermy natural world park display

You can see out over the park from a full-length glass window. There are animal dressing up costumes.

Costume room

This room has mannequins and dressing up.

Our Chelmsford

Quieter room with seating. Good 'chill out' space.

Victorian room

This room has a full wall projection of two men trading at the corn exchange. This video is on a motion sensor.