

A4/1a

PROPOSED ARTICLE 4 DIRECTION 2-89

CEDAR PARK, GRACES LANE, LITTLE BADDOW, ESSEX

O.S. PARCEL NUMBER 2533

SCALE 1:2500

DRAWN 3 JULY 1989

CHELMSFORD BOROUGH COUNCIL

PLANNING DEPARTMENT

Reproduced from Qor based upon the
Ordnance Survey Map with the permission
of the Controller of H.M. Stationery Office,
by Chelmsford Borough Council. Crown
Copyright Reserved. Licence No. LA 077 496

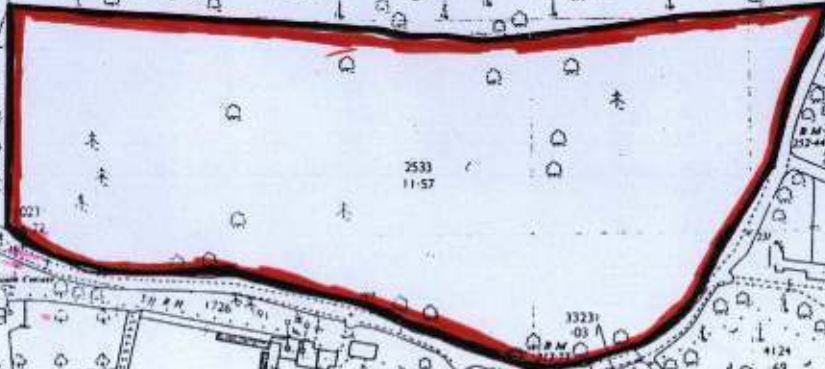
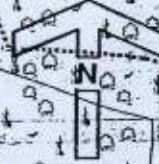

John Martin
MAYOR
DIRECTOR OF
ADMINISTRATION
BOROUGH OF CHELMSFORD

A4/19

REGISTERED AS A
PART..... ENTRY IN
LAND CHARGES REGISTER

Date 4th September 1989

Local Land Charges Register

Committee PLANNING.
Minute No. M11 PL40
Property Involved .. Bedn Park Riffhams Chase / Cornels Lane
(List)
.....
.....

Attached is a copy ~~and/or original~~ of Article 4 Direction
.....
.....
dated 4th September 1989 ~~198~~
which requires to be registered under Section of
the TOWN AND COUNTRY PLANNING ACT
~~Act.~~ * NB TO REMAIN IN FORCE FOR AN INITIAL PERIOD OF

Signed T. Anderson

Copy to:

- (1) L.L.C. Clerk
- (2) File No. 13/592/TA

A4/19

REGISTERED AS A
PART.....3.....ENTRY IN
LAND CHARGES REGISTER
DATE.....11/9/89.....

Map 193

Dated 4th September 1989

CHELMSFORD BOROUGH COUNCIL

TOWN AND COUNTRY PLANNING GENERAL DEVELOPMENT ORDER 1988

DIRECTION NO. 2/1989

Re: Cedar Park Little Baddow Nr Chelmsford Essex

M. J. Pratley
Director of Administration
Chelmsford Borough Council
Civic Centre
Duke Street
Chelmsford

Ref: 13592/TA

d79/13592(a). TA

CHELMSFORD BOROUGH COUNCIL
TOWN AND COUNTRY PLANNING ACT 1971
TOWN AND COUNTRY PLANNING GENERAL DEVELOPMENT
ORDER 1988

Direction restricting Permitted Development on land comprising 11.57 acres
owned by Mr. D Winter of 19 Hoynors Danbury Chelmsford Essex

Direction No. 2/1989

WHEREAS

(1) The Borough Council of Chelmsford being the Local Planning Authority for the District is satisfied that it is expedient that development of the description set out in the Schedule hereto should not be carried out on an area of land at Cedar Park Graces Lane/Riffhams Chase Little Baddow in the County of Essex as the same is shown edged red on the plan annexed hereto unless permission therefor is granted on an application made under the Town and Country Planning Act 1971 and the Town and Country Planning General Development Order 1988

(2) The said Council considers that development of the description set out in the Schedule hereto would constitute a threat to the amenities of its area and that the provisions of Article 5(4) of the said Order should apply to this direction

NOW THEREFORE the said Council in pursuance of the powers conferred upon it by Article 4 of the Town and Country Planning General

Development Order 1988 hereby directs that the permission granted by Article 3 of the said Order shall not apply to development of the description set out in the Schedule hereto on the said land

THIS DIRECTION is made pursuant to the provisions of Article 5(4) of the said Order and shall remain in force until

months from the date of this direction) and shall unless disallowed or approved by the Secretary of State before that date expire on that date

SCHEDULE hereinbefore referred to

The erection construction maintenance improvement or alteration of a gate fence wall or other means of enclosure

Given under the Common Seal of the Borough Council of Chelmsford in the County of Essex this *fourth* day of *September* One thousand nine hundred and eighty nine

The Common Seal of the
Borough Council of Chelmsford
was hereunto affixed in the
presence of: -

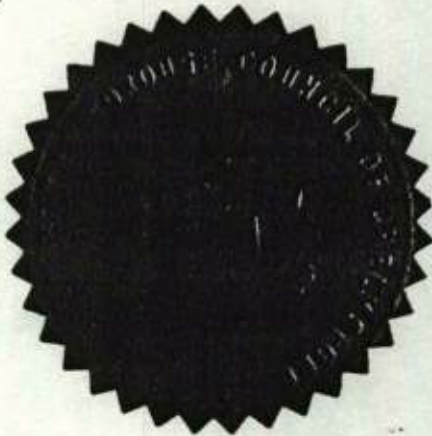

J. M. Martin
Mayor

M. H. Volney
Director of Administration

d79/13592(a).TA

A4/19.

REGISTERED AS A
PART.....³.....ENTRY IN
LAND CHARGES REGISTER
DATE.....29.1.90.....

NOTE TO LAND CHARGES SECTION

Town and Country Planning General Development Order 1988

Direction No 2/1989

Re: Cedar Park, Graces Lane/Riffhams Chase
Little Baddow, Essex

The above Direction has now been approved by the Secretary of State for the Environment on the 16th January 1990. No doubt that you will ensure that a permanent record of this is maintained in the Land Charges Register.

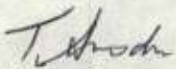

T Amodu
25th January 1990

C3/BH1/13592(d). TA

Dated

4th

September

1989

CHELMSFORD BOROUGH COUNCIL

TOWN AND COUNTRY PLANNING GENERAL DEVELOPMENT ORDER 1988

DIRECTION NO. 2/1989

Re: Cedar Park Little Baddow Nr Chelmsford Essex

M. J. Pratley
Director of Administration
Chelmsford Borough Council
Civic Centre
Duke Street
Chelmsford

Ref: 13592/TA

d79/13592(a). TA

CHELMSFORD BOROUGH COUNCIL
TOWN AND COUNTRY PLANNING ACT 1971
TOWN AND COUNTRY PLANNING GENERAL DEVELOPMENT
ORDER 1988

Direction restricting Permitted Development on land comprising 11.57 acres
owned by Mr. D Winter of 19 Hoynors Danbury Chelmsford Essex

Direction No. 2/1989

WHEREAS

(1) The Borough Council of Chelmsford being the Local Planning Authority for the District is satisfied that it is expedient that development of the description set out in the Schedule hereto should not be carried out on an area of land at Cedar Park Graces Lane/Riffhams Chase Little Baddow in the County of Essex as the same is shown edged red on the plan annexed hereto unless permission therefor is granted on an application made under the Town and Country Planning Act 1971 and the Town and Country Planning General Development Order 1988

(2) The said Council considers that development of the description set out in the Schedule hereto would constitute a threat to the amenities of its area and that the provisions of Article 5(4) of the said Order should apply to this direction

NOW THEREFORE the said Council in pursuance of the powers conferred upon it by Article 4 of the Town and Country Planning General

Development Order 1988 hereby directs that the permission granted by Article 3 of the said Order shall not apply to development of the description set out in the Schedule hereto on the said land

THIS DIRECTION is made pursuant to the provisions of Article 5(4) of the said Order and shall remain in force until **3 March 1990** ~~1990~~ (being six

months from the date of this direction) and shall unless disallowed or approved by the Secretary of State before that date expire on that date

SCHEDULE hereinbefore referred to

The erection construction maintenance improvement or alteration of a gate fence wall or other means of enclosure being development comprised within Class A of Part 2 referred to in Schedule 2 to the said Order and not being development comprised within any other part or class.

Given under the Common Seal of the Borough Council of Chelmsford in the County of Essex this *Fourth* day of *September* One thousand nine hundred and eighty nine

The Common Seal of the
Borough Council of Chelmsford
was hereunto affixed in the
presence of: -



)
)
)
)
J. Morstan
Mayor

M. Sholey
Director of Administration

d79/13592(a). TA

The Secretary of State for the Environment
hereby approves the foregoing direction
subject to the modifications shown in red ink
thereon.

R. A. Bird

Signed by authority
of the Secretary of
State

* A Regional Controller
in the Department of
the Environment.

16 January 1990

CHELMSFORD BOROUGH COUNCIL

Memorandum

From Director of Administration

To Local Land Charges Dept

Telephone ext. 2159

My Ref: C1/jmq/13592.TA

Your Ref:

Date:

15th August 1989

Article 4 Direction -
Cedar Park, Graces Lane/Riffhams Chase, Little Baddow

On 18th July 1989 the Planning Committee resolved to serve an Article 4 Direction in respect of the above land, in order to prevent minor operations under Class Part 2 of the Second Schedule to the general development order. I would be pleased if you would therefore take any appropriate action.

Ms. Bentley
2

CHELMSFORD BOROUGH COUNCIL PLANNING DEPARTMENT

Reproduced from a map based upon the
Ordnance Survey Map with the permission
of the Controller of H.M. Stationery Office,
by Chelmsford Borough Council, Crown
Copyright Reserved. Licence No. LA 077 496

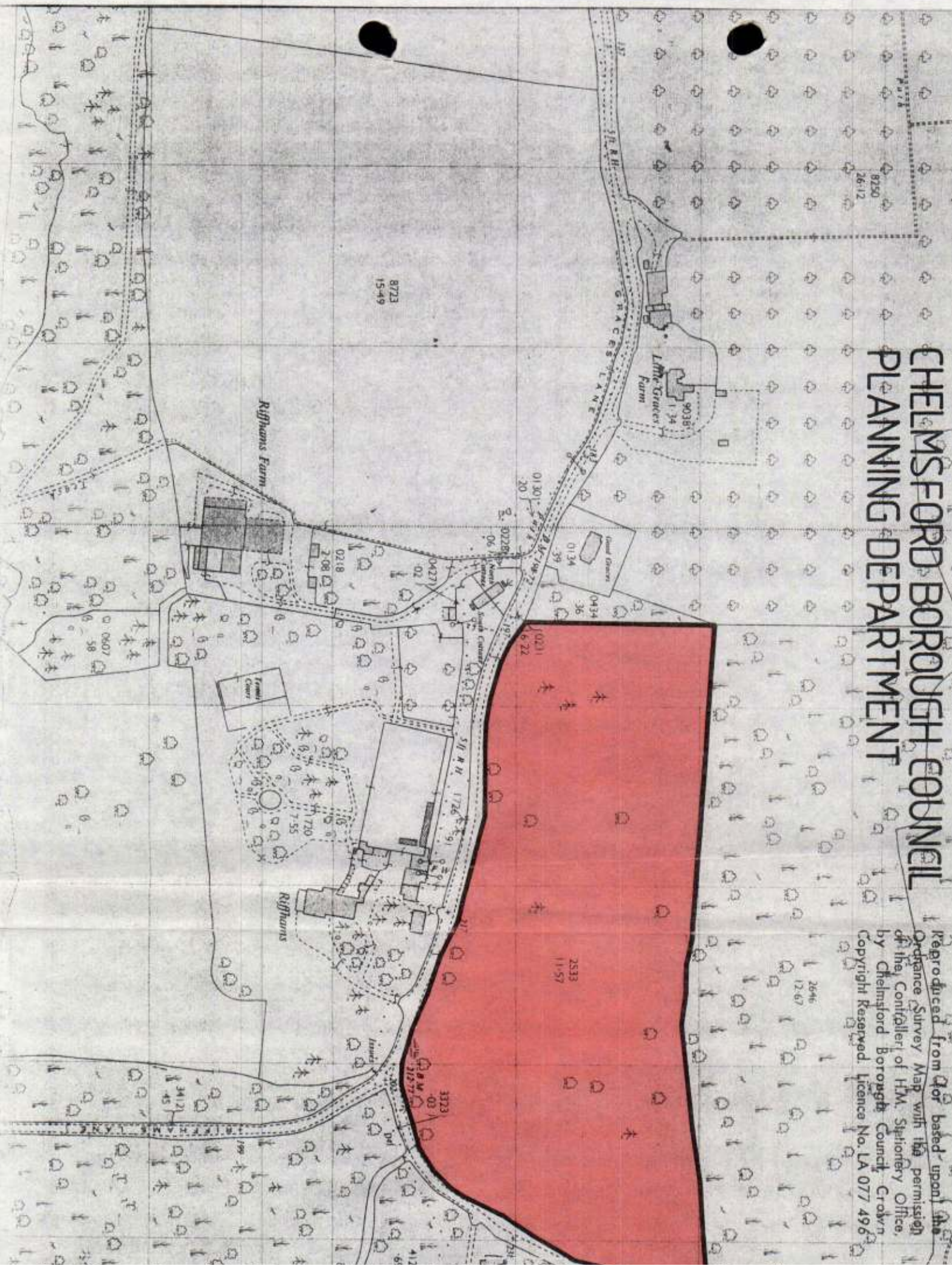

Reproduced from aor based upon the
Ordnance Survey Map with the permission
of the Controller of H.M. Stationery Office,
by Chelmsford Borough Council Crown
Copyright Reserved. Licence No. LA 077 496

Rifflands Farm

2533
11-57

Reproduced from aor based upon the
Ordnance Survey Map with the permission
of the Controller of H.M. Stationery Office,
by Chelmsford Borough Council Crown
Copyright Reserved. Licence No. LA 077 496

CHELMSFORD BOROUGH COUNCIL PLANNING DEPARTMENT

BOROUGH OF CHELMSFORD

John St. Martin
MAYOR
DIRECTOR OF
ADMINISTRATION

Riffhams Farm

9038
L.M.P. Graces
Farm

GRACES LANE

2533
11.57

266
12.67

Produced from aor based upon the
Office Survey Map with the permission
of the Controller of H.M. Stationery Office,
Chelmsford Borough Council - Crown
Copyright Reserved, Licence No. LA 077496

